

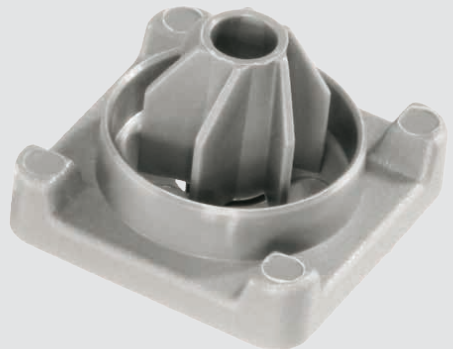

# X-ET DATA SHEET

**Nail for fastening plastic electrical  
cable tray and junction box**



# X-ET Nail for fastening plastic electrical cable tray and junction box

## Product data

### Dimensions

X-ET UK-H27

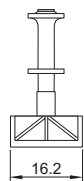
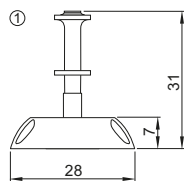

UK-H27

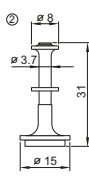

X-ET MX

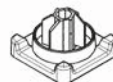

w x l x h = 16.5 x 16.5 x 12 mm

X-GHP 20/24

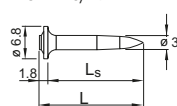

X-GN 27

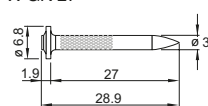

X-EGN 14

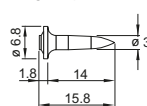

X-U 16/22/27

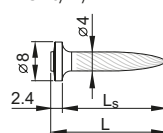

X-P 20/24 G3 MX

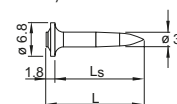

X-P 20/24 B3 MX

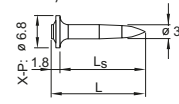

X-P 22/27

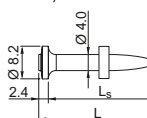

X-C 27 G3 MX

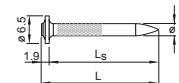

X-S 14 G3 MX

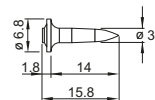

X-S 14 B3 MX

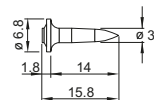

### Material specifications

X-ET Polyethylene (PE)

X-ET MX Polyamide (PA), halogen and silicone free, light grey (RAL 7035) and Polybutylenterephthalate (PBT), silicone free, flame retardant, stone grey (RAL 7030)

### Recommended fastening tools

DX 6 MX, DX 5 MX, DX 460 MX, DX 351 MX  
 DX 6 F8, DX 5 F8, DX 460 F8, DX 351, DX 2  
 GX 120-ME, GX 3-ME, BX 3-ME



• See fastener program in the next pages.

## Applications

### Examples



Cable trunking

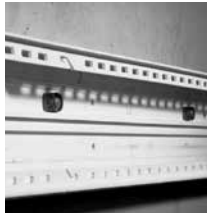

Cable trunking



Junction boxes



Conduits & pipes with metal or textile band

## Performance data

### Recommended service load

Designation	Service load
X-ET MX	0.1 kN



- Recommended service load is determined by the serviceability of the plastic part.

## Application recommendation

### Base material thickness

#### Concrete

X-U, X-P:	$h_{min} = 80 \text{ mm}$
X-P B3 MX:	$h_{min} = 60 \text{ mm}$
X-P G3 MX, X-GHP:	$h_{min} = 60 \text{ mm}$
X-C 27 G3 MX, X-GN 27 MX:	$h_{min} = 60 \text{ mm}$

#### Steel

$t_{II} \geq 4 \text{ mm}$

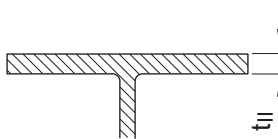

## Corrosion information



- These zinc-coated fasteners are not suitable for long-term service outdoors or in otherwise corrosive environments.
- For more details, please refer to following technical document: Hilti Corrosion Handbook.

### System recommendation



- For more details, please refer to the chapter **Accessories and consumables compatibility** in the Direct Fastening Technology Manual (DFTM).

### Installation information

#### Conditions for use

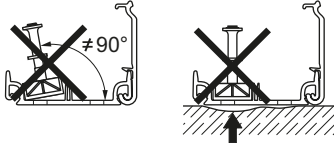

- No fastenings on ribs
- Underside of trunking must be smooth
- X-ET MX only in pre-drilled holes

#### Trunking dimensions and properties

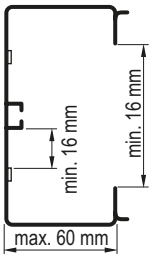

- Material thickness:  $t_1 \leq 2 \text{ mm}$
- Material: PVC

### Power-actuated tool and fastener recommendation

Base material	Cable holder	Power-actuated tool	Fastener
Concrete or masonry	X-ET MX	GX 3-ME	X-P 20/24 G3 MX
			X-C 27 G3 MX
		GX 120-ME	X-GHP 20/24 MX
			X-GN 27 MX
	X-ET UK-H27	DX 6 MX, DX 5 MX, DX 460 MX, DX 351 MX	X-U 22/27 MX
		X-P 22/27 MX	
Steel	X-ET MX	GX 3-ME	X-S 14 G3 MX
			X-EGN 14 MX
		BX 3-ME	X-S 14 B3 MX
	X-ET UK-H27	DX 6 MX, DX 5 MX, DX 460 MX, DX 351 MX	X-U 16 MX

### Cartridge recommendation for fastening to concrete and masonry

Base material	Cartridge color (tool power level)	
	Tool type: DX 6 MX	Tool type: DX 5 MX, DX 460 MX, DX 351 MX
	DX 6 F8	DX 5 F8, DX 460 F8, DX 351 F8, DX 2
	Cartridge type: 6.8/11 M	Cartridge type: 6.8/11 M
Sand lime masonry	titanium ■ (1-5)	green ■, yellow ■
Soft/medium concrete	titanium ■ (2-5)	yellow ■, red ■
Tough concrete	titanium ■ (4-8)	yellow ■, red ■



- Tool power level adjustment by setting tests on site.
- Start tool energy selection with lowest recommended tool power level.

### Cartridge recommendation for fastening to steel

Base material	Cartridge color (tool power level)	
	Tool type: DX 6 MX	Tool type: DX 5 MX, DX 460 MX, DX 351 MX
	DX 6 F8	DX 5 F8, DX 460 F8, DX 351 F8, DX 2
	Cartridge type: 6.8/11 M	Cartridge type: 6.8/11 M
S235, S275, S355	$4 \leq t_{\parallel} \leq 14 \text{ mm}$	titanium ■ (2-8)  yellow ■, red ■



- Tool power level adjustment by setting tests on site.
- Start tool energy selection with lowest recommended tool power level.

### System recommendation for gas-actuated tools

GX tools	GX 120-ME	Gas can GC 20, GC 21 and GC 22
	GX 3-ME	Gas can GC 40, GC 41 and GC 42

### Fastener program

Item no. and description

Designation	Item no.	Description
X-ET UK-H27	251705	X-ET
X-ET MX	285718	